

# PRACTI-NITRO PATCH™

## INSTRUCTIONAL GUIDELINES

The Practi-Nitro Patch™ simulates a transdermal infusion system for student practice. The intention is to simulate the Nitro-Dur Transdermal System without the presence of medication. All Practi-Nitro Patches are safe and are Latex free. However, we suggest applying the Practi-Patch onto a manikin or surface other than human skin.

1. Begin instruction by reviewing the nature of nitroglycerin, its actions, side-effects, and normal dosages. Have the student explain the side-effects the patient may experience before applying the Practi-Patch. These should include but are not limited to, flushing of the skin and an increase in heart rate. Next, have the student calculate the amount of released drug the patient will receive per hour and per day before beginning the application.
2. Follow the instructions below for application and removal of the Practi-Nitro Patch. Following the transdermal application, have the student chart the medication properly in the correct format.

### PLACEMENT AREA

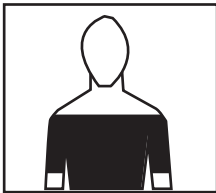

1. Select a reasonably hair-free application site. Avoid extremities below the knee or elbow, skin folds, scar tissue, burned or irritated areas

7. Press the sticky side on the skin, and smooth down

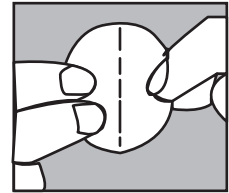

### APPLICATION

2. Wash hands before applying

3. Hold the unit with scored lines facing you, in an up and down position

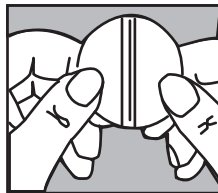

8. Fold back the remaining side of the patch. Grasp the edge of the plastic applicator and pull it across and discard. Press gently on patch to adhere

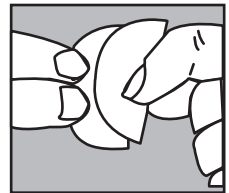

4. Bend the sides of unit away from you, then toward you until you hear the "SNAP"

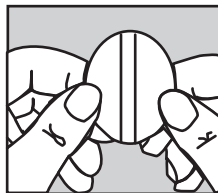

9. Wash hands to remove any drug

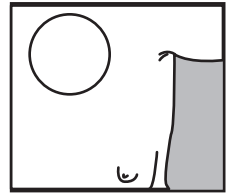

5. Peel off one side of the plastic backing

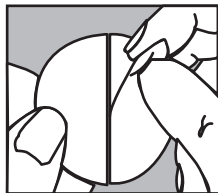

6. Using the other half of the backing as a handle, apply the sticky side of the patch to the skin

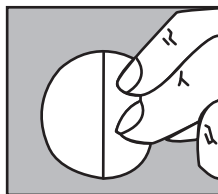

### REMOVAL OF PATCH

1. Press down on the center of the system to raise its outer edge away from the skin

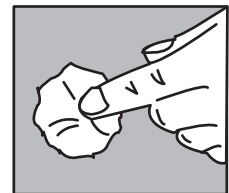

2. Grasp the edge gently, and slowly peel the unit away from the skin

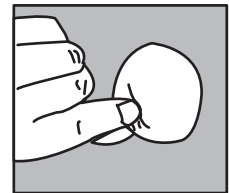

3. Wash skin area with soap and water. Towel dry. Wash hands